

Adapters

QFP64 - TET

Target CPU package: QFP64
 Body size: 10 mm x 10 mm
 Pitch: 0.5 mm
 POD target layout: T_QFP144

Can be used with:

- MC9S12XFR128 Active PRO POD

Note that adapter solutions stated in the document can be used only with listed PODs. Disregarding this warning may result in hardware failure of the target and the emulation system.

► Available Adapter Parts (by ordering code):

- **IA64ATQ-SOLDER**

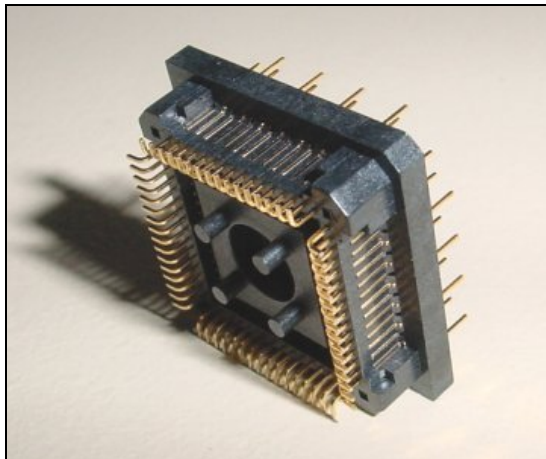

Solder part, which is being soldered to the target.

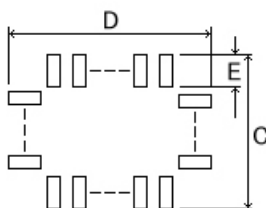

(Unit: mm)						
A	B	C	D	E	K	L
12	1.505	13.0	13.0	2.3	14	14

Recommended (by TET) PCB footprint size

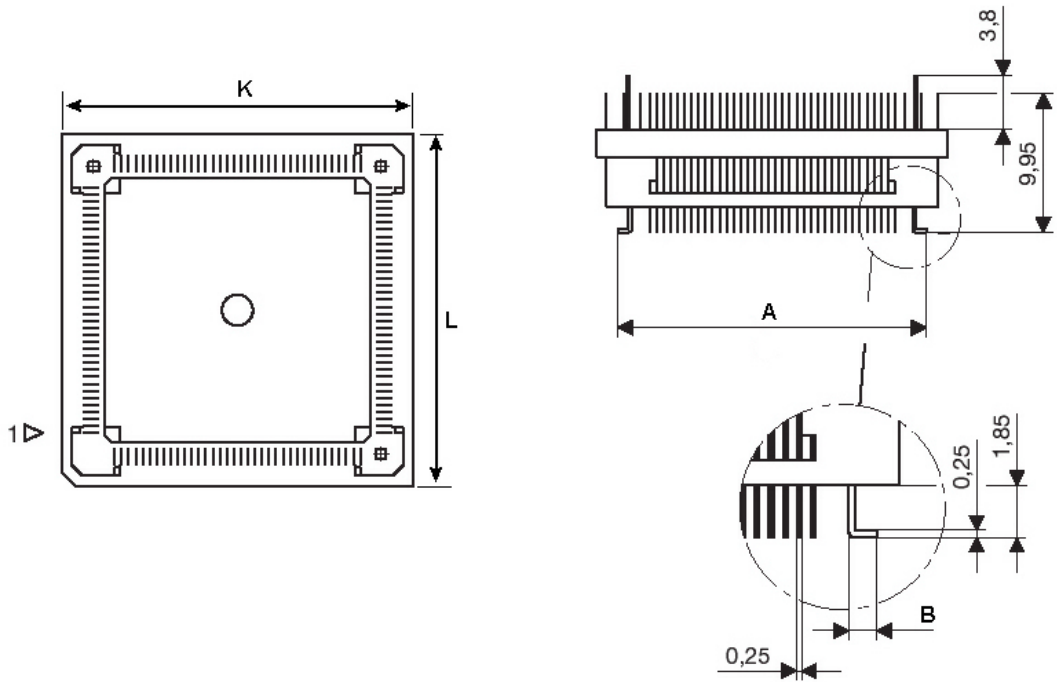

- **IA144P64A-W-XFR**

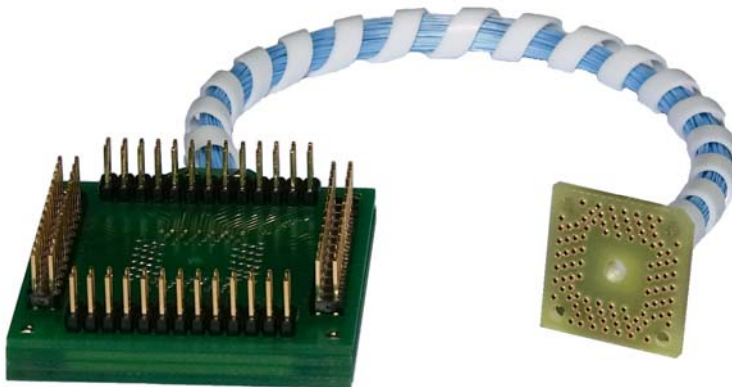

The IA144P64A-W-XFR represents flexible connection between the POD and the target. Above picture does not show exactly the IA144P64A-W-XFR but IA100TQ-WIRE which looks exactly the same considering that it has different pin count and pin layout.

- **IA64ATQ-CPU**



The IA64ATQ-CPU is used to connect the CPU directly to the target.

Connecting the CPU directly to the target

The CPU can be connected directly to the target using the IA64ATQ-SOLDER in combination with the IA64ATQ-CPU. This solution is very suitable for an ultimate test.

Step 1: Solder the IA64ATQ-SOLDER to the target PCB.

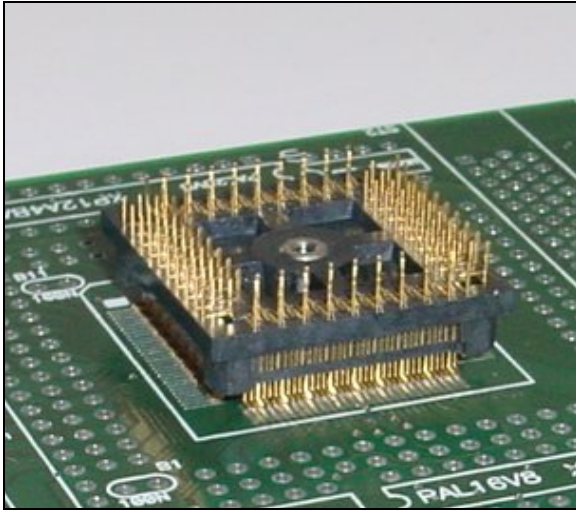

Step 2: Insert the CPU into the IA64ATQ-CPU, which then connects to the IA64ATQ-SOLDER.